

ext. 80 bar

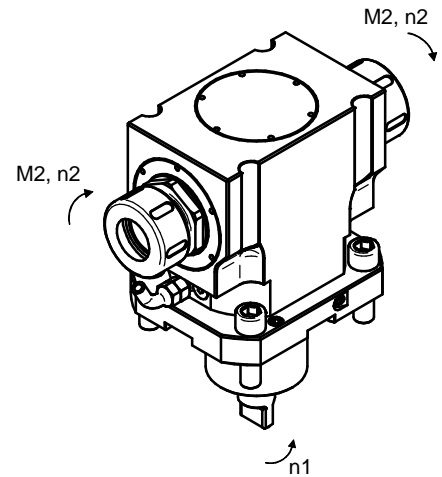
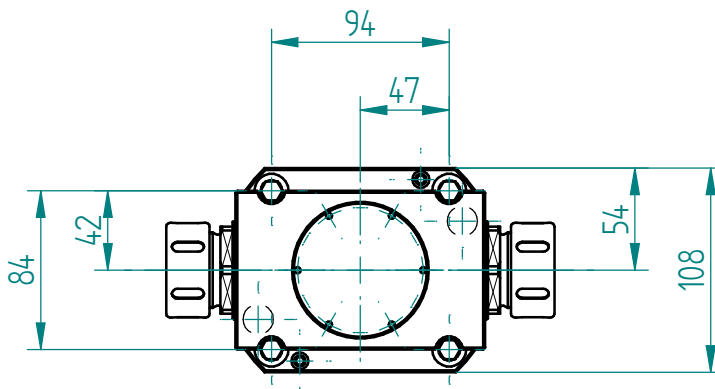
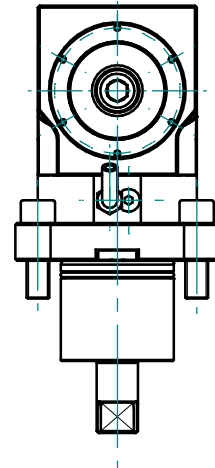
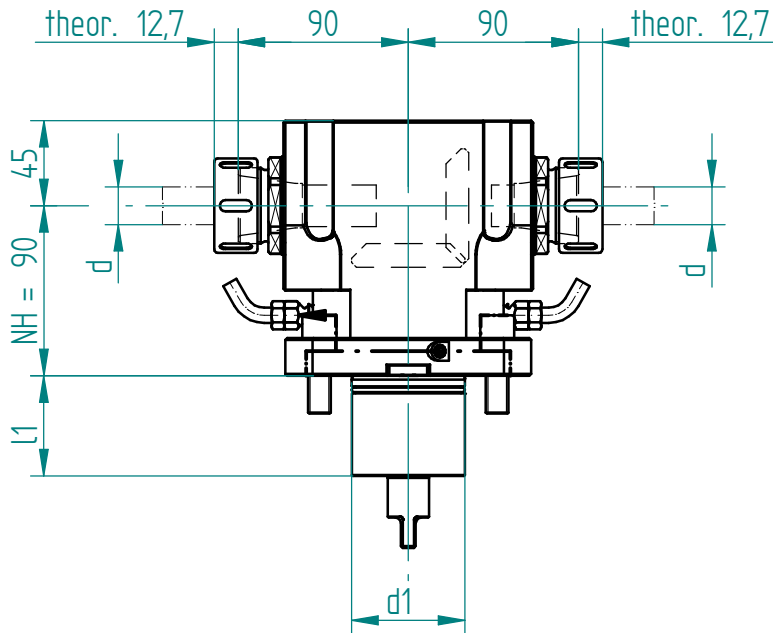

Änderungen vorbehalten. Subject to modification

Schaft shank		Drehmoment torque	Drehzahl tool speed	Leistung output	Übersetzung gear ratio	Wkzg.Aufnahme Spannbereich tool holding fixture clamping range	Kupplung coupling	Ausführung version	Bestell-Nr. order N°
d1 mm	l1 mm	M2 max Nm	n2 max 1/min	P max KW	i = n1: n2	Spannbereich d chucking capacity d			
60	53	100.0	6000	5.5	-1.00	DIN 6499 - 32 - A 2-20	Mori Seiki	universal universal	121437

Erforderliche(r) Schlüssel zur Werkzeugspannung / necessary key(s) for tool clamping

122194