

Typenblatt  
Data Sheet

Angetriebenes Werkzeug gerade  
Werkzeugaufnahme Solidfix  
*straight driven tool ; tool location Solidfix*

**SAUTER**  
Mit uns dreht die Welt!

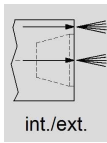
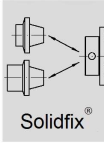
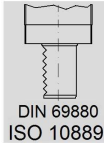

int. 5-80 bar  
ext. 80 bar  
-  $\diamond$  50  $\mu$ m  
- Dry run: 100%

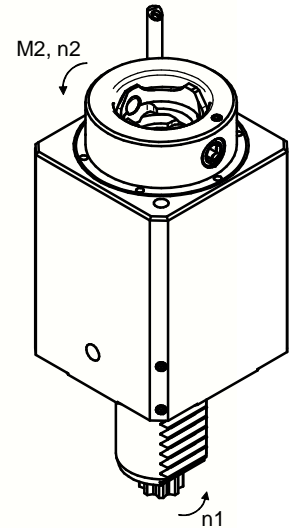
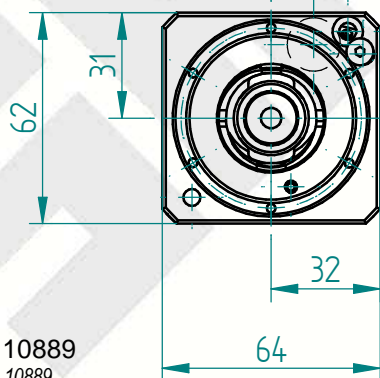
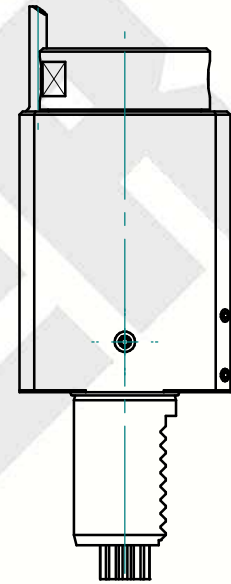
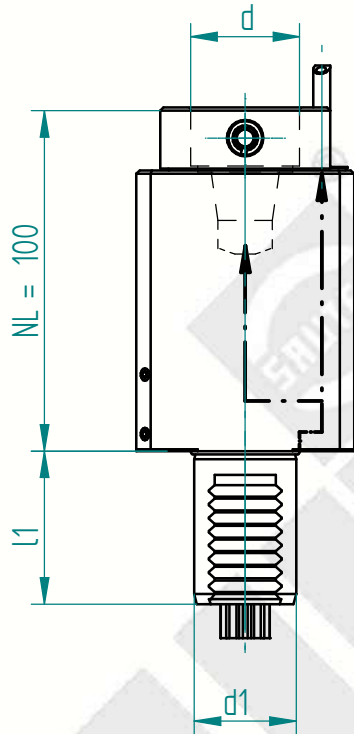

\*nicht nach ISO 10889  
\*not according to ISO 10889

Schnittstelle Revolver <i>interface tool turret</i>		Drehmoment <i>torque</i>	Drehzahl <i>tool speed</i>	Leistung <i>output</i>	Übersetzung <i>gear ratio</i>	Wkzg.Aufnahme Spannbereich <i>tool holding fixture clamping range</i>	Ausführung <i>version</i>	Bestell-Nr. <i>order N°</i>	
Schaft <i>shank</i>	Kupplung <i>coupling</i>								
ISO 10889									
d1 mm	l1* mm	M2 max Nm	n2 max 1/min	P max KW	i = n1: n2	Spannbereich d <i>chucking capacity d</i>			
30	45.0	DIN 5482 B 15x12	32.0	7000	8.0	1.00	Solidfix S3	gerade <i>straight</i>	<b>138194</b>

Erforderliche(r) Schlüssel zur Werkzeugspannung / *necessary key(s) for tool clamping*

Inbusschlüssel / *Allen head wrench*

